



Domel's direct drive motor for e-bike application with Pedelec system does not use any pinions or gears. With its high efficiency, low weight and low noise it represents a very competitive solution on the market with high ratio between weight and torque. Low energy consumption at nominal power 250 W by 25 km/h and maximal power 650 W allows user to drive longer with the same battery capacity. Our motor is designed in accordance with EnergyBus Standard.



E-BIKE

DOMEL, Elektromotorji in gospodinjski aparati, d.o.o.
Otoki 21, 4228 Železniki, Slovenija
www.domel.si
petra.lotric@domel.si
jaka.kavcic@domel.si



DOMEL[®]
Sustainable innovative solutions



E-BIKE

MOTOR PERFORMANCE

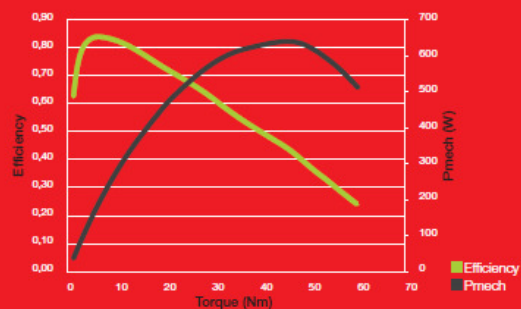

The latest Domel's development product is highly efficient e-bike motor. This motor is purely a result of our internal activities with the help of state of the art optimization tools and our engineer's knowledge of permanent magnet motors which allows us to exploit active materials at a very high level. Such approach is environmentally friendly and at the same time we are following Domel's vision in order to preserve as much material as possible.

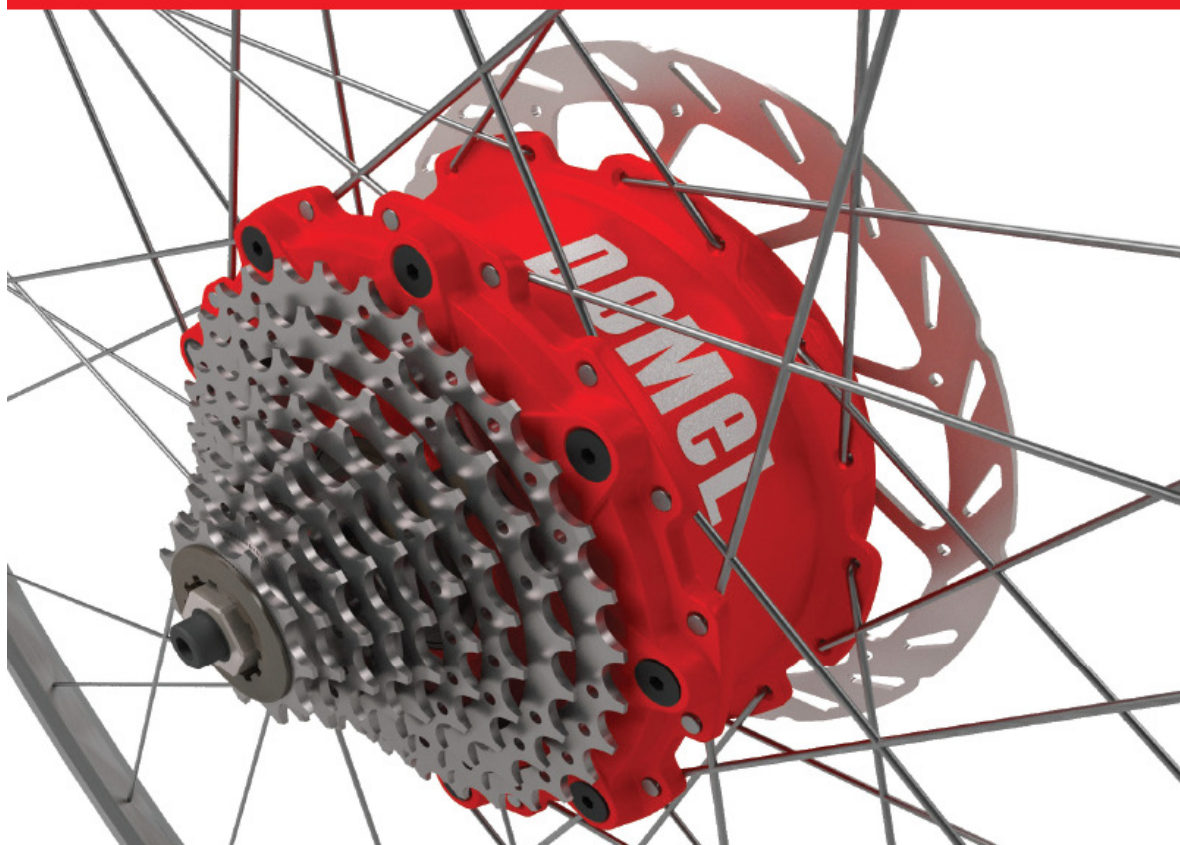
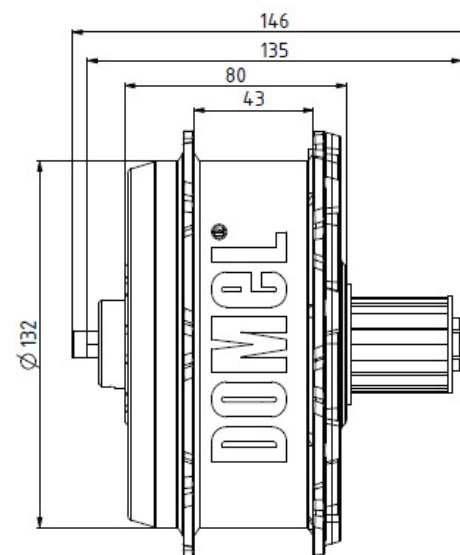

TECHNICAL DATA

Shaft length: 135 mm / 146 mm
Motor diameter: 132 mm

Nominal power: 250 W
Maximal power: 650 W
Nominal torque: 7,5 Nm
Maximal torque: > 55 Nm
Motor efficiency: $\leq 88\%$
Voltage supply: 36 V / 48 V DC

Motor weight: 3,8 kg
Protection level: IP54